

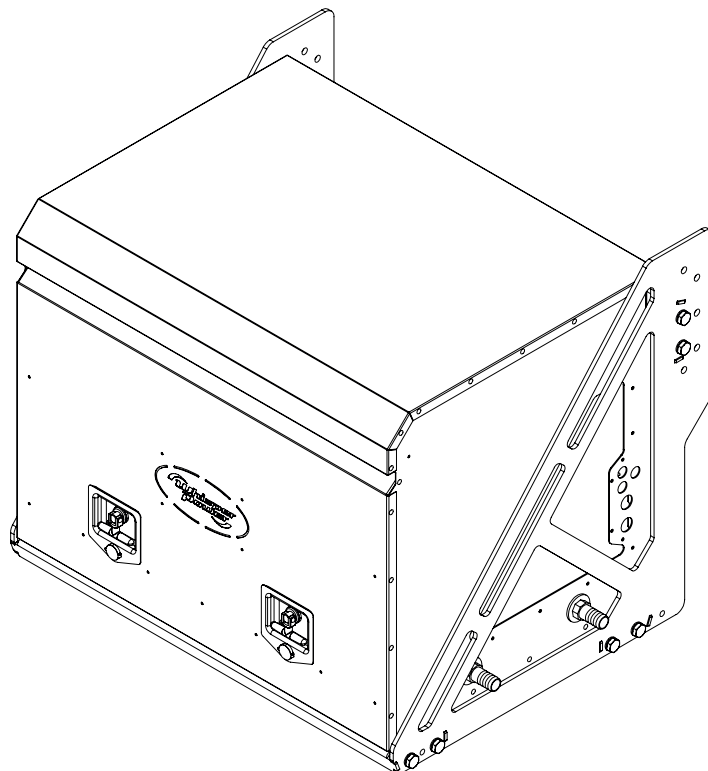

AC Series

W-GV 15 Elite Outdoor

Phase: single-phase or split-phase | **Volts:** 230 V or 240 / 120 | **Hertz:** 50 / 60 Hz



Generator Weights and Dimensions

General specification	
Weight kg (lb.)	260 (preliminary) (573)
Depth mm (in.) incl. suspension frame	742 (29,21)
Width mm (in.) incl. suspension frame	907 (35,71)
Height mm (in.) incl. suspension frame	736 (28,98)

* Incl suspension frame, see drawing for all dimensions

Generator Power Output Specifications

Power Output	
Intermittent Power kW	12,5
Continuous power Kva at 25°C (77°C)	15
Continuous power kW at 25°C (77°C)	12

Engine Features

- Diesel fueled
- Certified by Environmental Protection Agency (EPA) to conform the Tier III mobile auxiliary
- Three cylinder
- Four stroke
- Stage V
- Closed cooling system
- Exhaust manifold
- Electric fuel lift pump
- Lifting eye

Benefits

- Little noise from the engine and generator
- Independence: Enough energy in your home or vehicle, so you don't have to constantly charge the batteries via the grid

Generator Features

- High efficient brushless synchronous alternator
- Class H insulation
- Speed adjustability
- Liquid cooled
- Engine and generator are thermally separated from each other

WhisperPower reserves the right to change the design or specifications without notice and without any obligation or liability whatsoever. Contact your local WhisperPower distributor for availability.



AC Series

W-GV 15 Elite Outdoor

Application Data 1

Generator Engine

Engine Specifications	
Type	Kubota D1105
Cylinder quantity	3
Displacement, L (cu. In.)	1,123 (68,53)
Bore, mm (in.)	78 (3,07)
Stroke, mm (in.)	78,4 (3,09)
Compression ratio	24:1
Combustion system	IDI
Nominal speed, rpm	2700
Max. power at rated rpm, kW	12,5
Governor, type	Mechanical
Angular operation continuous	25°
Engine Electrical System	
Battery, voltage	12 V
Battery, charging module	40 A
Battery, minimum recommendation	90Ah
Cooling System	
Capacity, L, approx.	TBD
Heat extraction	Single or Topcool
Thermostat	N.A.
Fuel System	
Fuel shut off solenoid	Electrical (ETR)
Fuel injection pump	Mechanical
Fuel lift pump	Electrical
Maximum recommended Fuel lift, m (ft.)	0.8 (2.62)
Lubrication System	
Oil pump type	Pressure
Oil filter type	External
Oil pan capacity with filter, L (gal.)	TBD (l)
Oil type	WPL-10W40

Operation

Operation Requirements	
Engine Speed RPM	2200-3200
Air requirements, m³/hr (cu.ft)	85,8 (3030)
Fuel Consumption l/hr	4,2-5,6
Optional: Crankcase heater	

Other Specifications

Exhaust system	R1,5 inch, dry
	Pre-mounted with optional chassis dependent adapter
Suspension frame	fixation plate
Minimal required free top space	100mm

Engine Certificates

The Kubota Z482 has the certificates below

- Regulation (EU) 2016/1628
- Implementing Regulation (EU) 2018/988
- Delegated Regulations (EU) 2018/987 and (EU) 2018/989

Engine Features

- Low oil pressure shutdown
- High engine temperature shutdown
- Low vibration shock mounts
- Disposable oil filter
- Oil drain plug
- Disposable water/ fuel filter

Alternator Features

- Brushless, rotating field design permits power to be obtained from stationary leads.
- Windings are vacuum impregnated with epoxy varnish for dependability and long life.
- Rotors are dynamically balanced to minimize vibration.
- Copper windings ensure minimal heat build-up.

- Insulation meets NEMA standards for class H insulation.
- Flexible connected to the engine. The generator has double sealed precision ball bearing with a precision-machined steel sleeve in the end bracket to prevent shaft misalignment and extend bearing life.

General Conditions

- Ventilated environment required
- Operating temperature of -10 °C / + 40 °C
- Storage temperature of -20 °C / +70 °C
- Relative humidity in operations / storage of max 75% RH, no-condensing



AC Series

W-GV 15 Elite Outdoor

Application Data 2 - DDC Configuration

Generator Control Basic



DDC

- Full engine control
- Robust digital sensor readout
- Basic monitoring of conventional and PM technology generators
- DDC RS485 communication to Whisper Touch Panel LCD display with all important information about the output and load
- The load bar shows the real time delivered load
- Engine will stop in the event of a fault
- It is possible to have the generator start and run according to a pre-programmed schedule
- It is possible to have the generator start and stop according to a pre-programmed schedule
- Language by choice. German, English, French, Italian, Dutch and Spanish.

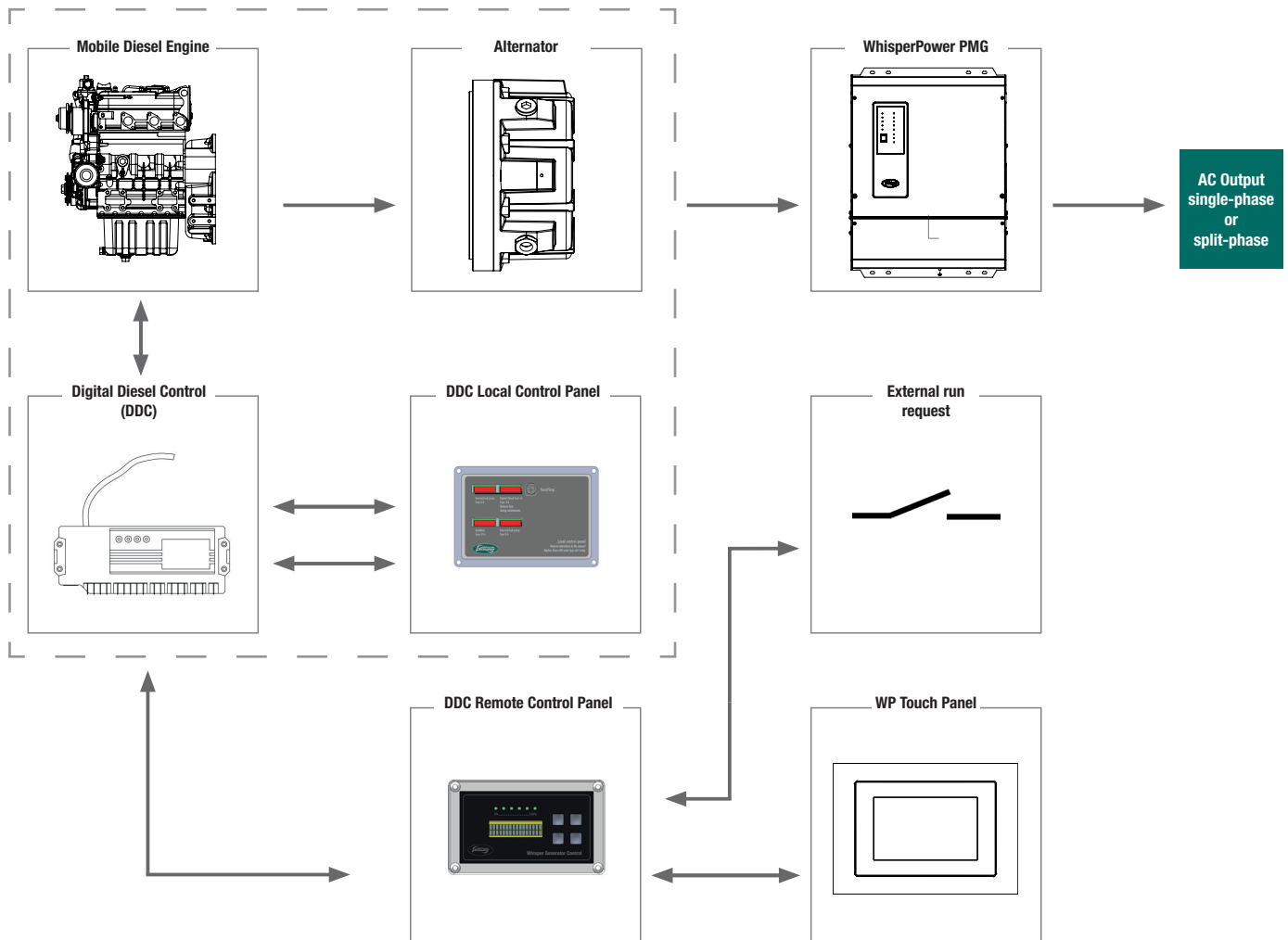



AC Series

W-GV 15 Elite Outdoor

Drawing 1

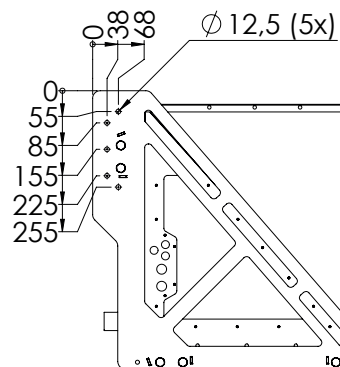
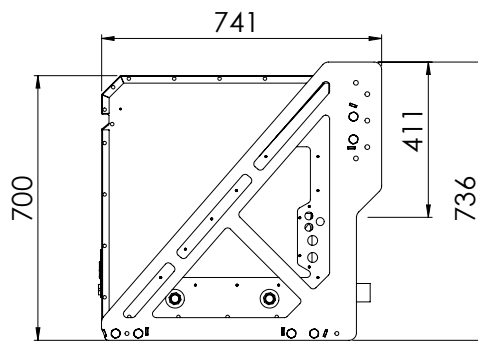
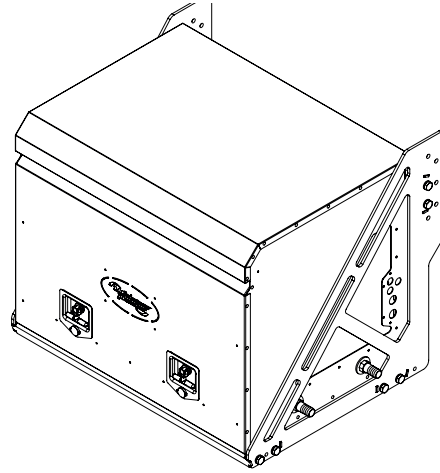
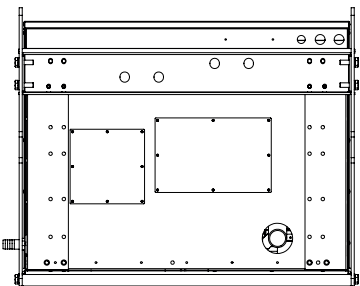
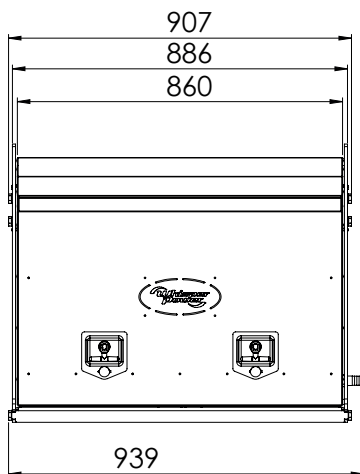
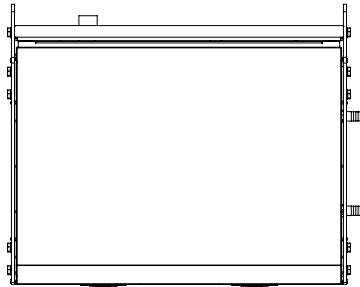



AC Series

W-GV 15 Elite Outdoor

Drawing 2

1.	Fuel in
2.	Fuel return
3.	Coolant out (Warm)
4.	Coolant in (Cold)
5.	Suspension bracket
6.	Exhaust pipe
7.	Start battery wire positive
8.	Start battery wire negative
9.	DDC data cable
10.	AC Power cable
11.	Air intake
12.	Oil drainage cover
13.	Oil fill cap
14.	Oil dipstick
15.	Fuel Filter
16.	Fuel pump
17.	Air filter
18.	DDC local control panel (start/stop)
19.	Generator fusing
20.	Oil filter
21.	Starter motor
22.	Manifold

